

Filter Array, 2xPi

33826002S

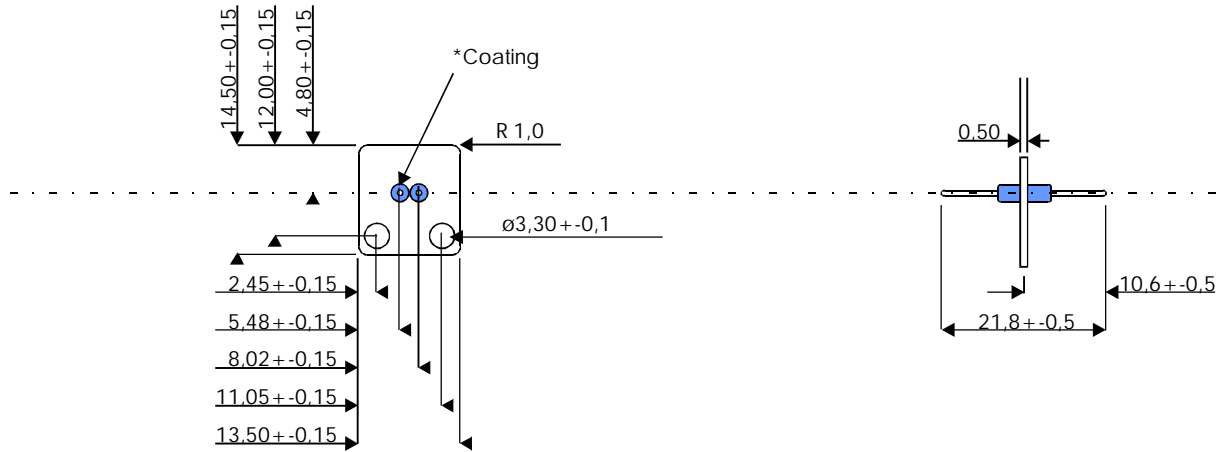

Groundplate: Nickel-silver, Sn-plated
 Connectorpin: Brass, Ni-plated, Au-plated
 * Coating: SB 240 Blue Dipping grade from ESL
 Solderjoint between Groundplate and filter: Sn62

Working voltage.....	100Vdc
Test voltage.....	250Vdc
Feed through current.....	max 5A
Insulation resistance.....	min 10 ⁴ MΩ
IEC category.....	55/085/56
Capacitance.....	2x1nF GMV
Inductance.....	100nH GMV
Marking.....	none

Attenuation (typical values)	1MHz	2dB
	10MHz	25dB
	100MHz	65dB
	1000MHz	80dB

Filter Array, 12x2xPi

33826004S

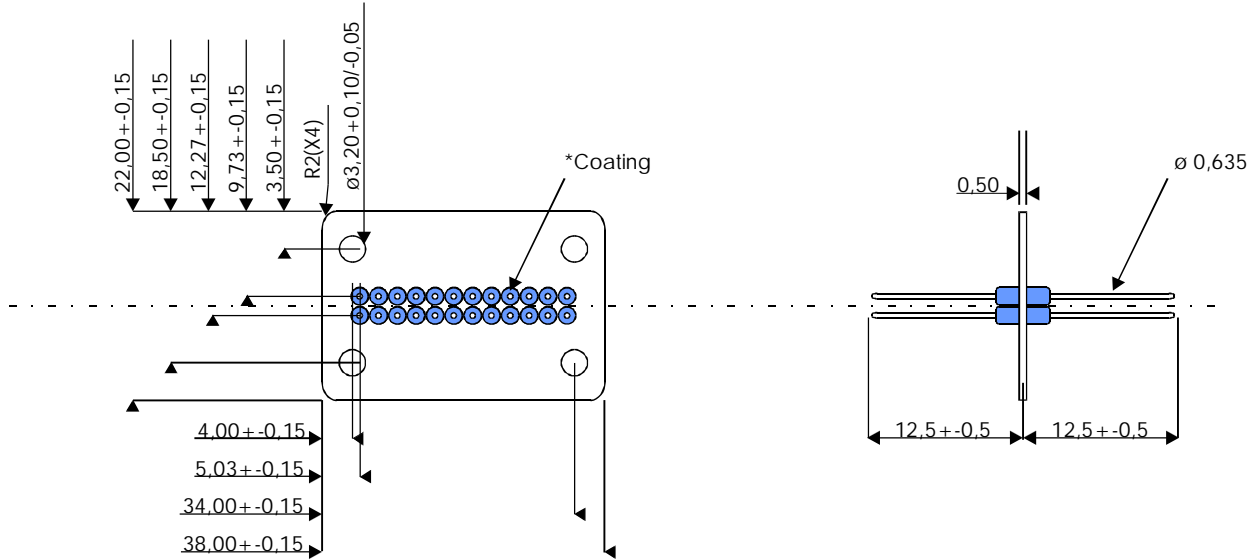

Groundplate: Nickel-silver, Sn-plated
 Connectorpin: Brass, Ni-plated, Au-plated
 * Coating: SB 240 Blue Dipping grade from ESL
 Solderjoint between Groundplate and filter: Sn62

Working voltage.....	100Vdc
Test voltage.....	250Vdc
Feed through current.....	max 5A
Insulation resistance.....	min 10 ⁴ MΩ
IEC category.....	55/085/56
Capacitance.....	2×1nF GMV
Inductance.....	100nH GMV
Marking.....	none

Attenuation (typical values)	1MHz	2dB
	10MHz	20dB
	100MHz	50dB
	1000MHz	80dB

Filter Array, 12x2xPi

33826006S

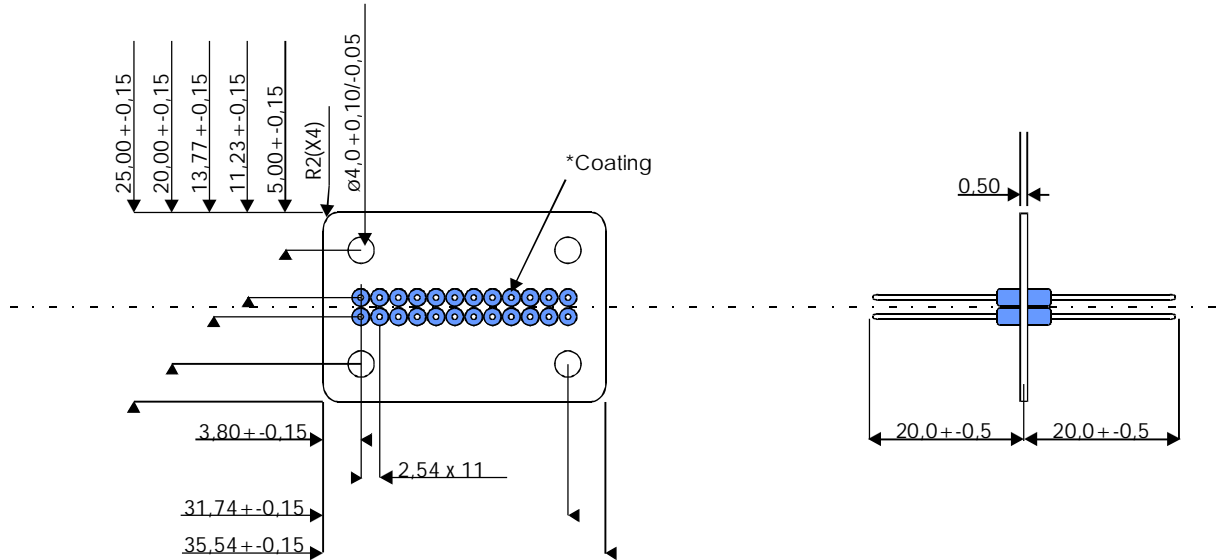

Groundplate: Nickel-silver, Sn-plated
 Connectorpin: Brass, Ni-plated, Au-plated
 * Coating: SB 240 Blue Dipping grade from ESL
 Solderjoint between Groundplate and filter: Sn62

Working voltage.....	100Vdc
Test voltage.....	250Vdc
Feed through current.....	max 5A
Insulation resistance.....	min 10 ⁴ MΩ
IEC category.....	55/085/56
Capacitance.....	2x1nF GMV
Inductance.....	100nH GMV
Marking.....	none

Attenuation (typical values)	1MHz	2dB
	10MHz	25dB
	100MHz	65dB
	1000MHz	80dB

Filter Array, 6x2xPi

33826007S

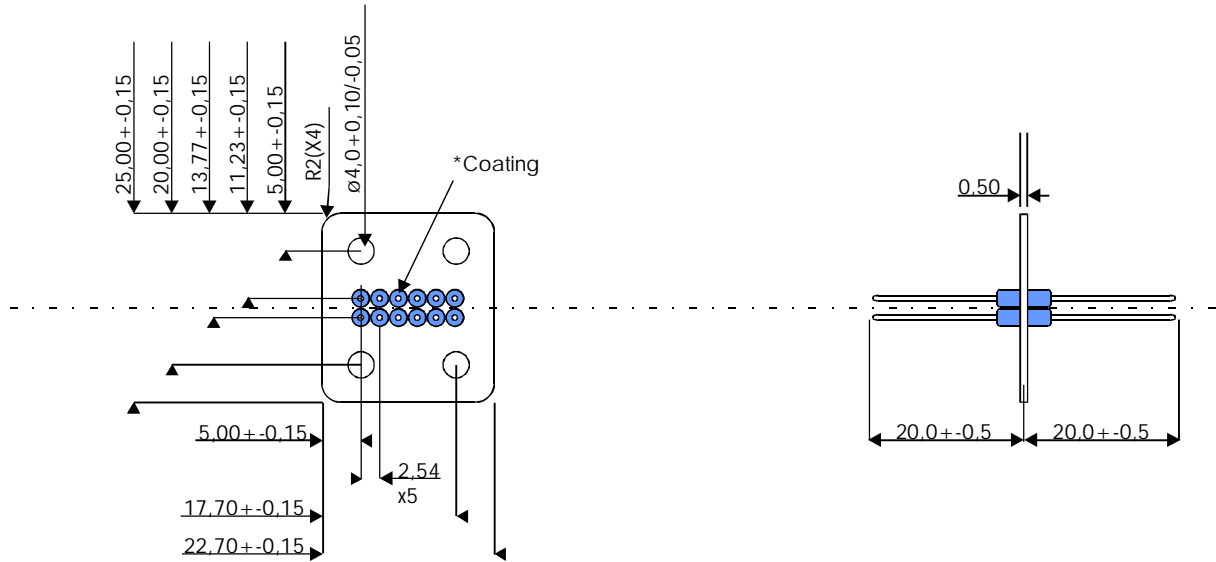

Groundplate: Nickel-silver, Sn-plated
 Connectorpin: Brass, Ni-plated, Au-plated
 * Coating: SB 240 Blue Dipping grade from ESL
 Solderjoint between Groundplate and filter: Sn62

Working voltage.....	100Vdc
Test voltage.....	250Vdc
Feed through current.....	max 5A
Insulation resistance.....	min 10 ⁴ MΩ
IEC category.....	55/085/56
Capacitance.....	2×1nF GMV
Inductance.....	100nH GMV
Marking.....	none

Attenuation (typical values)	1MHz	2dB
	10MHz	25dB
	100MHz	65dB
	1000MHz	80dB

Filter Array, 3x2xPi

33826008S

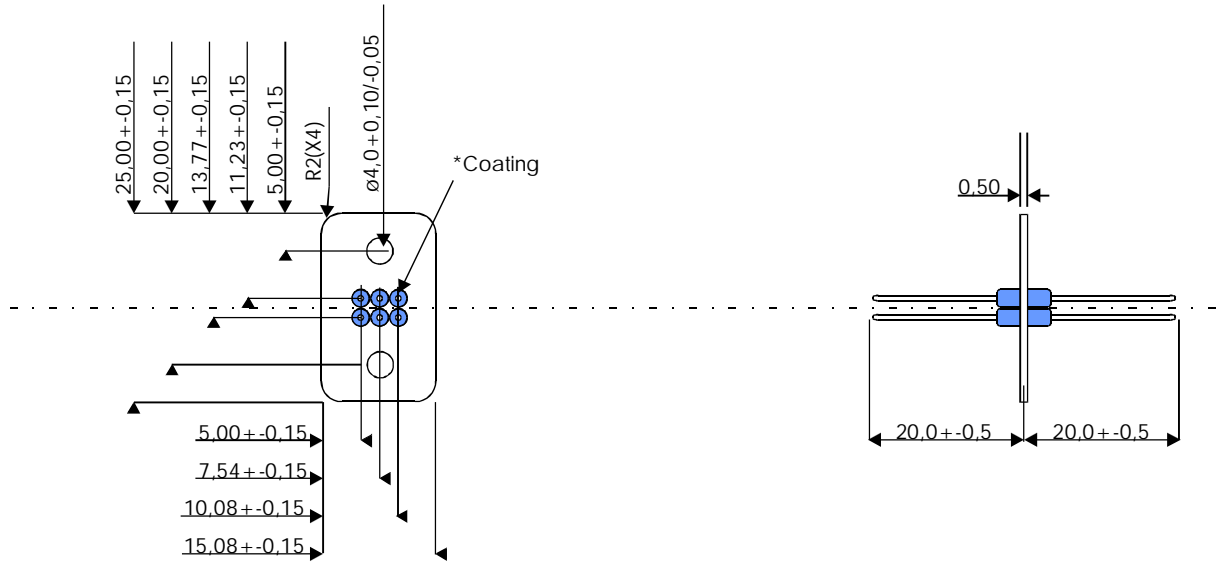

Groundplate: Nickel-silver, Sn-plated
 Connectorpin: Brass, Ni-plated, Au-plated
 * Coating: SB 240 Blue Dipping grade from ESL
 Solderjoint between Groundplate and filter: Sn62

Working voltage.....	100Vdc
Test voltage.....	250Vdc
Feed through current.....	max 5A
Insulation resistance.....	min 10 ⁴ MΩ
IEC category.....	55/085/56
Capacitance.....	2x1nF GMV
Inductance.....	100nH GMV
Marking.....	none

Attenuation (typical values)	1MHz	2dB
	10MHz	25dB
	100MHz	65dB
	1000MHz	80dB